

IN THE BOX

Basic Gateway w/ Port Cover	Ethernet Cable	USB Power Adapter	USB Power Cable	Installation / User Guide

NOTE: Additional equipment may be required due to building construction or materials, or other radio interference that may reduce the radio range.

SAFETY INSTRUCTIONS

Read these instructions **before installing and using** the Basic Gateway and keep this guide in a safe place for future reference.

- **Verify compatibility** with your connected home system before installation.
- Follow all instructions provided by your connected home manufacturer regarding the addition of devices to your connected home system. An authorized, qualified installer may be required.

Salus accepts no responsibility for damage caused by not following these instructions.

CONTROLS, PORTS, AND INDICATORS

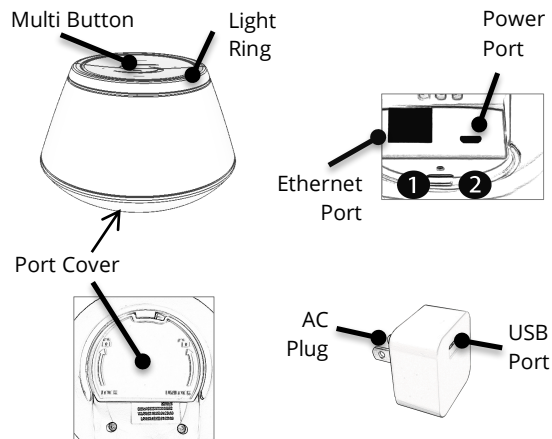

INSTALLING THE GATEWAY

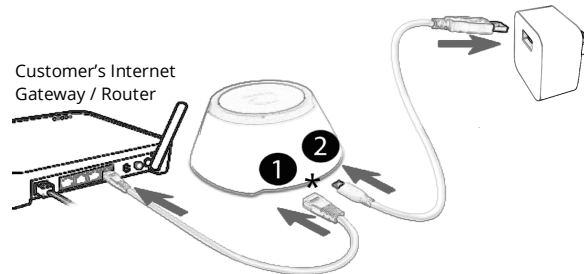

* The port cover under the gateway can be removed for easier access to the power and Ethernet ports.

Recommended cabling sequence: first connect the Ethernet cable to the gateway port, then attach the USB power cable to the gateway power port. Refer to the wyse.ly Pairing Guide for more information on how to connect the gateway to wyse.ly.

USING THE DEVICE

PAIRING DEVICES TO THE GATEWAY

- To pair devices to the gateway, first ensure the gateway is connected to the Internet (LED ring will be blue).
- Press the Multi Button until the LED ring flashes red (~3 seconds) and release to start the pairing process.
- Follow the instructions on wyse.ly or the wyse.ly app to complete the device pairing process. Repeat the process for each device.
- Press Multi Button again for more than 3 seconds to exit pairing state. The LED ring will turn solid blue when the pairing process is complete.

RESET TO FACTORY DEFAULTS

- To reset the device to factory default settings, press the Multi Button until the LED ring is a solid red (~10 seconds). The LED ring will flash red, then go solid red.
- Release the Multi Button when the LED ring is solid red. The device LED ring will turn solid green when it has been returned to factory default settings.

LED INDICATIONS

Connected = connected to wyse.ly

Linked = connected to local router

Paired = connected to local ZigBee devices

Solid Blue	On, Linked and Connected
Solid Green	Powering Up or On, Linked, NOT Connected
Solid Red	On, NOT Linked, NOT Connected
Flashing Green	Attempting to Connect or In IDENTIFY Mode
Flashing Red	Ready for Device Pairing

TROUBLESHOOTING

WILL NOT PAIR WITH DEVICES INITIALLY

- Radio interference is present at the desired location:
 - 1) Relocate the gateway;
 - 2) Select a different location for the device;
 - or 3) Add a ZigBee repeater to the system

DEVICE LOSS OF CONNECTION AFTER PAIRING

- Radio environment may have changed: (1) Force rejoin from device to possibly find a better radio path; or (2) Apply radio interference solutions above

Item	Description
Multi Button	Multi-function user input button: Pair, Rejoin, and Factory defaults
Light Ring	Tri-color ring of light to indicate status
AC Plug	NEMA 1 (Type A) plug - Compatible with US and Canadian standard 120 VAC, 15 A electrical outlets
USB Port	USB Type - A receptacle configured as a dedicated charging port
Ethernet Port	RJ-45 wired connection to the home Internet router/gateway
Power Port	USB micro-A port for power input
Port Cover	Protective cover for power and Ethernet ports

SPECIFICATIONS

Operating Conditions	32 – 104°F / 0 – 40°C 10 – 90% humidity (non-condensing)
Storage	-14 – 140 °F / -10 – 60°C
Protocols Supported	ZigBee HA 1.2 profile WiFi 802.11n
RF Freq.	2.4 GHz
Input voltage	120VAC ±10%, 60 Hz
Size	Ø 3.5" x 2.2" / Ø 89 x 56 mm

FCC STATEMENTS

WARNING: Changes or modifications to this unit not expressly approved by the party responsible for compliance could void the user's authority to operate the equipment.

This device complies with Part 15 of the FCC Rules. Operation is subject to the following two conditions: (1) this device may not cause harmful interference, and (2) this device must accept any interference received, including interference that may cause undesired operation.

NOTE: This equipment has been tested and found to comply with the limits for a Class B digital device, pursuant to Part 15 of the FCC Rules. These limits are designed to provide reasonable protection against harmful interference in a residential installation. This equipment generates, uses and can radiate radio frequency energy, and if not installed and used in accordance with the instructions, may cause harmful interference to radio communications. However, there is no guarantee that interference will not occur in a particular installation. If this equipment does cause harmful interference to radio or television reception, which can be determined by turning the equipment off and on, the user is encouraged to try to correct the interference by one or more of the following measures:

- Reorient or relocate the receiving antenna.
- Increase the separation between the equipment and receiver.
- Connect the equipment into an outlet on a circuit different from that to which the receiver is connected.
- Consult the dealer or an experienced radio/TV technician for help.

FCC AND INDUSTRY CANADA

RF Radiation Exposure statement: This equipment complies with FCC and Industry Canada RF radiation exposure limits set forth for an uncontrolled environment. This equipment should be installed and operated with a minimum distance of 20 centimeters between the antenna and all persons.

INDUSTRY CANADA

This device complies with Industry Canada licence-exempt RSS standard(s). Operation is subject to the following two conditions: (1) this device may not cause interference, and (2) this device must accept any interference, including interference that may cause undesired operation of the device.

Le présent appareil est conforme aux CNR d'Industrie Canada applicables aux appareils radio exempts de licence. L'exploitation est autorisée aux deux conditions suivantes : (1) l'appareil ne doit pas produire de brouillage, et (2) l'utilisateur de l'appareil doit accepter tout brouillage radioélectrique subi, même si le brouillage est susceptible d'en compromettre le fonctionnement.

SALUS WARRANTY

SALUS North America, Inc. ("Salus") warrants that for a period of five (5) years ("Warranty Period") from the date of purchase by the consumer ("Customer"), this device, excluding batteries ("Product"), shall be free of defects in materials and workmanship under normal use and service in accordance with all supplied instructions. During the warranty period, Salus shall, at its option, repair or replace any defective Products, at no charge for the device. Any replacement and/or repaired devices are warranted for the remainder of the original Warranty Period or ninety (90) days, whichever is longer.

This warranty does not cover removal or reinstallation costs. This warranty does not apply to any Product (i) which has been modified, repaired, or altered, except by Salus or an authorized Salus representative, (ii) which has not been maintained in accordance with any handling or operating instructions supplied by Salus, or (iii) which has been subjected to unusual physical or electrical stress, misuses, abuse, negligence or accidents.

This warranty is the only express warranty Salus makes for the Product. Any implied warranties, including warranties of merchantability or fitness for a particular purpose, are limited to the Warranty Period or the shortest period allowed by law.

SALUS SHALL NOT BE LIABLE FOR ANY LOSS OR DAMAGE OF ANY KIND, INCLUDING ANY SPECIAL, INCIDENTAL OR CONSEQUENTIAL DAMAGES RESULTING, DIRECTLY OR INDIRECTLY, FROM ANY BREACH OF ANY WARRANTY, EXPRESS OR IMPLIED, OR ANY OTHER FAILURE OF THIS PRODUCT. Some states and provinces do not allow the exclusion or limitation of incidental or consequential damages, or limitation on the duration of implied warranties of merchantability or fitness, so these exclusions or limitations may not apply to you.

No oral or written information or advice given by Salus or a Salus-authorized representative shall modify or extend this warranty. If any term is held to be illegal or unenforceable, the legality or enforceability of the remaining terms shall not be affected or impaired.

Customer's sole and exclusive remedy under this limited warranty is product repair or replacement as provided herein. If a Product under warranty is defective, the Customer may:

- contact the party ("Seller") from which the Customer purchased the Product to obtain an equivalent replacement product after the Seller has determined that the Product is defective and the Customer is eligible for a replacement, or
- contact Salus Service at support@salusinc.com, to determine whether the device qualifies for a replacement. If a replacement is warranted and is shipped prior to the return of the device under warranty, a credit card is required and a hold may be placed on the Customer's credit card for the value of the replacement until the returned device is verified as eligible for replacement, in which case, the Customer's credit card will not be charged.

This warranty gives you specific legal rights, and you may also have other rights that vary from jurisdiction to jurisdiction. If you have any questions regarding this warranty, please write Salus at:

SALUS North America, Inc.
850 Main St.
Redwood City, CA 94063